



25' Sport Scope Instruction Manual

Dear Customer,

We appreciate your business and value your support for our product. At Sport Scope, we strive to provide our customers with quality, easy to use, and affordable end zone camera systems. We are confident that you will feel that we have met all your expectations.

Thank You,

Sport Scope Staff

Travel Bag Layout

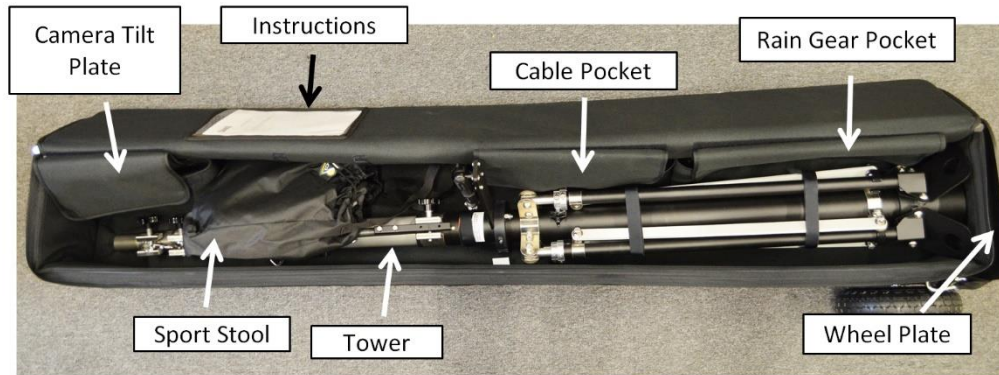

Hard Case Layout

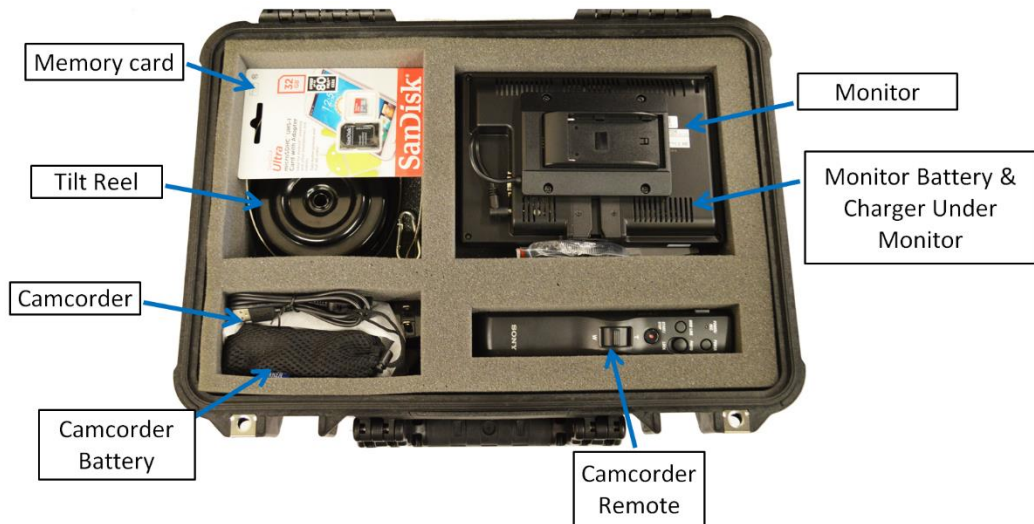

Attaching Hard Case to Travel Bag



Camera Set Up

When you get your camera you will need to change a few settings to make it work properly with your Sport Scope.

Turn Off Power Save

Power Save turns the camera off after 5 minutes.

In the Setup menu

- 1) Select **Setup**
- 2) Select **Power Save**
- 3) Select **Off**

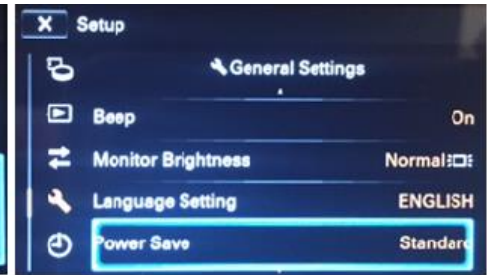

Set Record Quality to HD

- 1) Select **Image Quality/Size**
- 2) Select **REC Mode**
- 3) Select **High** or **Highest Quality**



View Record and Battery Info on LCD Monitor

- 1) Select **Camera/Mic**
- 2) Select **Scene Selection**
- 3) Select **Bottom right arrow**
- 4) Leave on last screen

This is an optional step for those interested in displaying Record/Standby & Battery Info on the monitor screen. You are **not** required to perform this step.

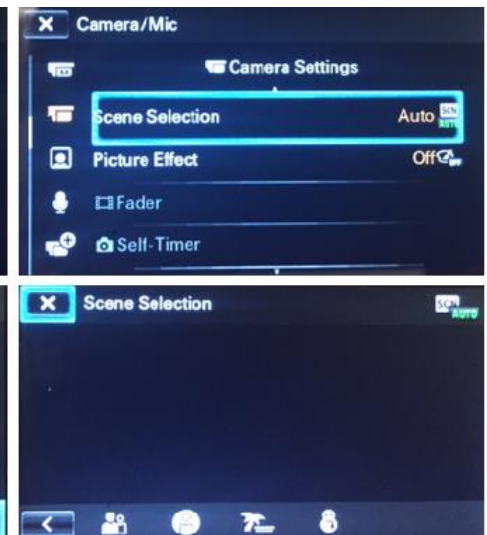
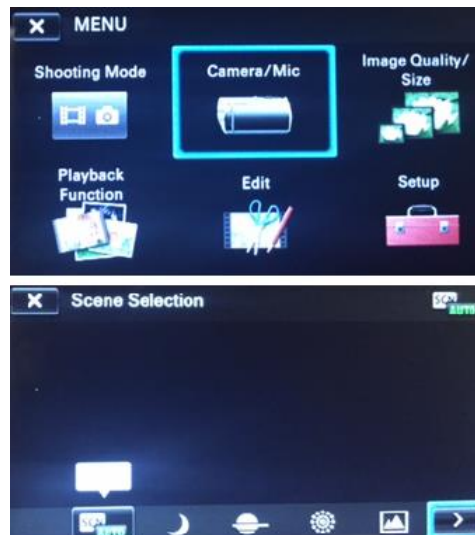

Set Up Instructions

Unzip the travel bag and unstrap the Sport Scope tower.

(1) Unhook the wheel plate strap from the back end of the travel bag. (2) Gently pull the tower from the wheel plate. (3) Gently pull wheel plate from travel bag.

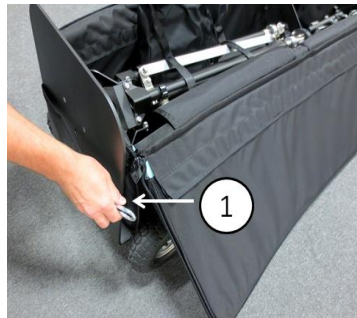

(1) Place the wheel plate on the ground and put the tower into it. This will allow you to move the Sport Scope around and onto a level area for filming. (2) Open each leg and place the foot firmly on ground by stepping onto it, especially when setting up on long grass.

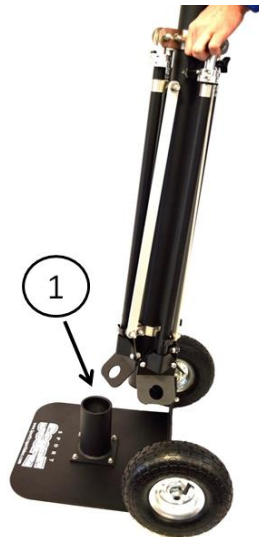

(1) Make sure each axis is level by using the movable compact level. (2) Tighten each leg knob tight as you level the tower. After the legs are locked, check to make sure the tower is still level. If it is not level, make the necessary adjustments.

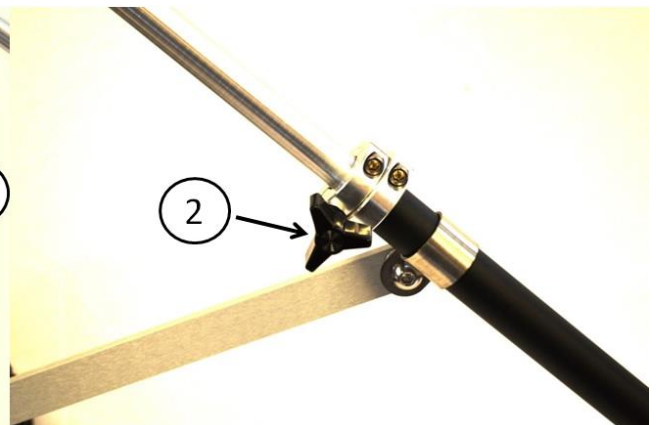
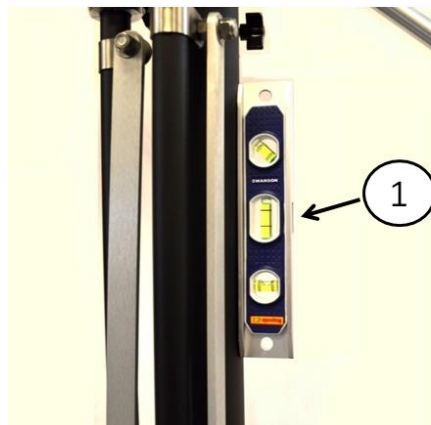

- (1) Lift the pan/tilt handle up.
 (2) Unscrew the black knob from the pan/tilt handle so that it exposes (3) the threaded rod.

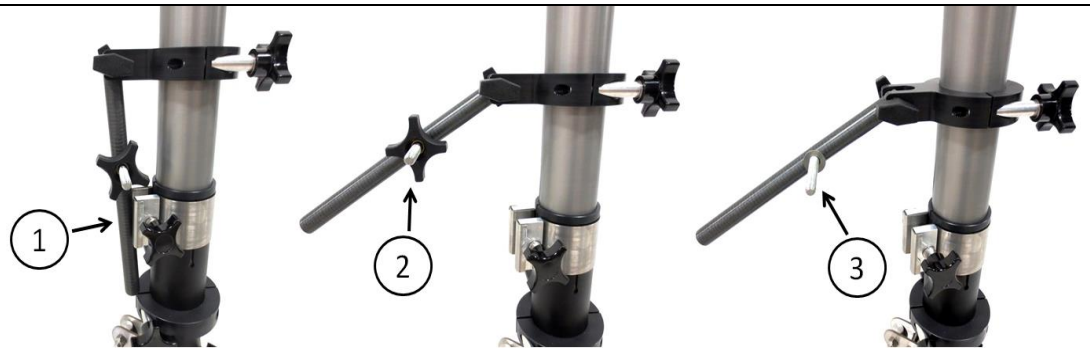

- (1) Take the tilt reel out of the hard case and slide it over the threaded rod. Then tighten the black knob back into place. (2) Next, take the remote handle out of the hard case and slide it onto the pan/tilt handle.



- (1) Take the camera tilt plate out of the travel bag and place into the top pole of the tower. (2) Next, loosen the knob as shown to give the (3) tilt reel cable enough slack to extend.



- (1) Connect the tilt reel cable to the back of the (2) camera tilt plate as shown. This will allow the camera to tilt up and down.

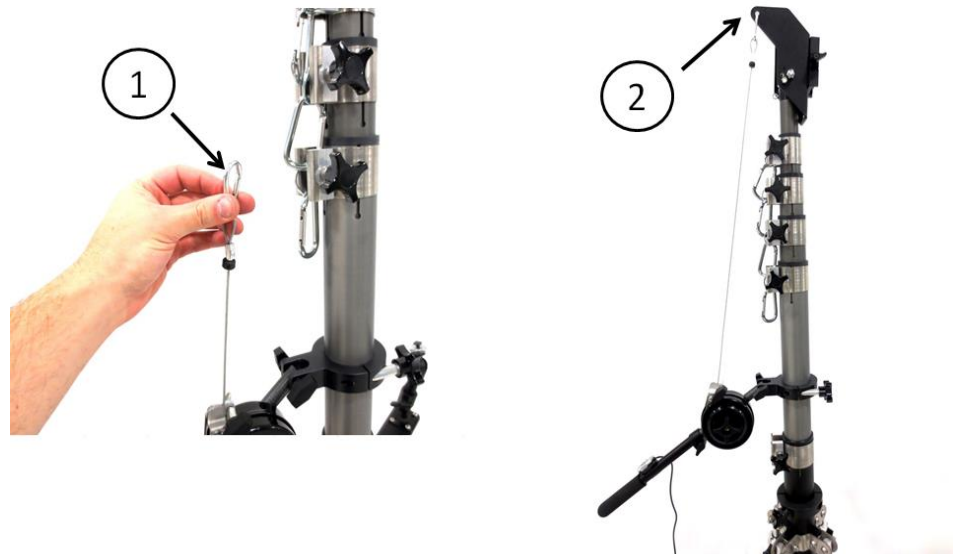

(1) Take the quick release plate off the camera tilt plate and connect it to the bottom of the camcorder. (2) Slide the camera into the quick release from the top as shown. (3) Position the camera forward on the camera tilt plate and tighten the knob as shown.

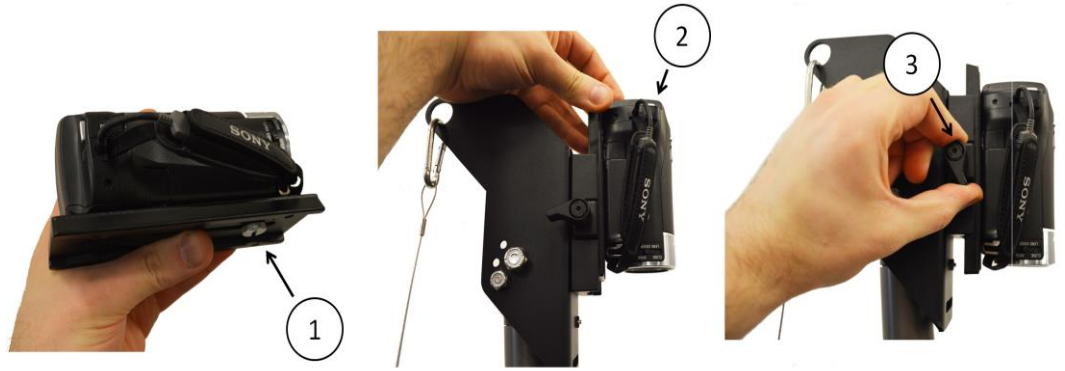

Remove camera from quick release to connect battery. (1) First open viewfinder to turn **ON** camera. Next turn **ON** extended battery **BEFORE** connecting to camera. (2) Connect USB cord from camera to extended battery.



IMPORTANT: Do **NOT** turn camera off during half time or you must repeat this process. Turning camera off to save battery life is not necessary.

(1) Slide extended battery into camera handle and use Velcro strap to tighten. (2) Re-attach camera to the Pan/Tilt head.



(1) Attach the monitor to the swivel mount by sliding the monitor onto the swivel mount's square knuckle and (2) by tightening the silver knob against the back of the monitor.

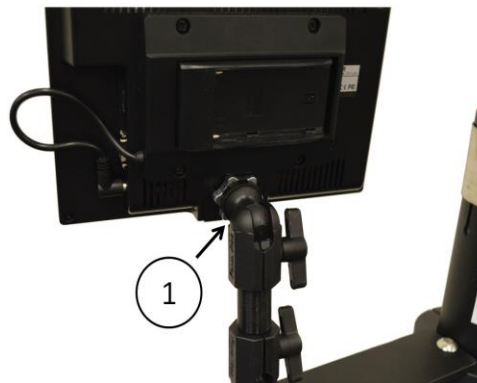

(1) Position the monitor by using the swivel mount's t-handle knobs. The swivel mount can position the monitor in almost any direction. (2) Next, attach a charged monitor battery to the back of the monitor by sliding it into the battery plate.

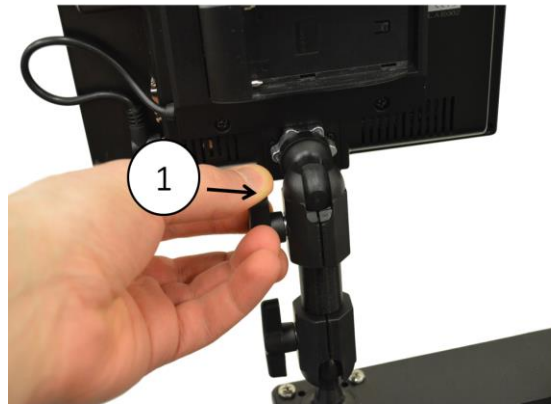

IMPORTANT (1) Take out the 25' cable from the travel bag and then (2) attach the cable's carabineer to the eye-hold screw found on the back of the camera tilt plate. This will act as a cable strain relief to protect the camera connections as you raise the tower.

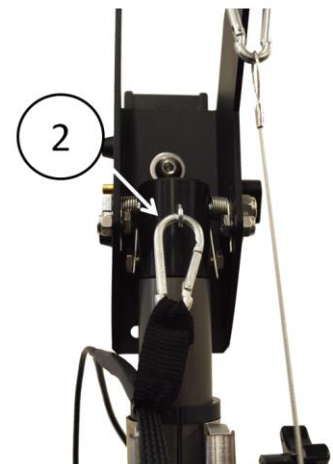
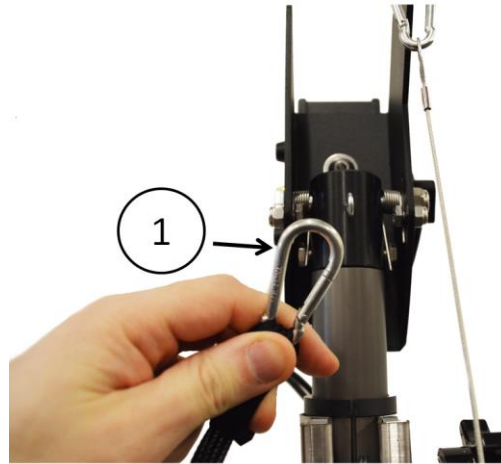

(1) Connect the HDMI cable into the side of the camera. This will give you a video feed down to the monitor. (2) Next, connect the multiport connection into the camera's MULTI port.

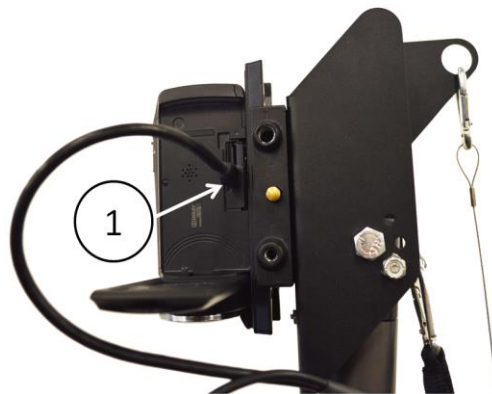

(1) Connect the HDMI cable from the 25' cable into the side of the monitor. (2) Connect the light grey end of the multiport cable into the camera remote.

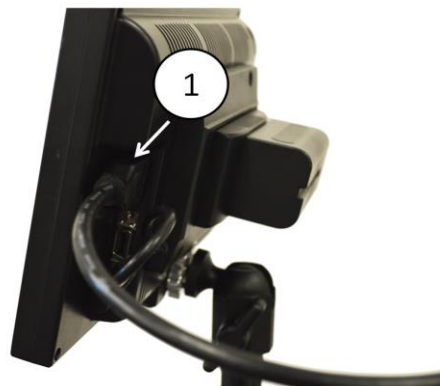

Now that all the electronics and cable connections are setup, it is time to raise the tower. (1) First, loosen the four-arm knob to free up the tilt reel. (2) Next, rotate the tilt reel forward as shown and then tighten the four-arm knob back into place securing the tilt reel again. (3) Finally, loosen the black t-handle knob to allow the tilt reel cable enough slack to extend.

IMPORTANT (1) Loosen the top knob until the first pole is loose and then raise the top pole with **both hands**. Once you reach your desired height, (2) tighten the knob to lock the pole into place.

(1) Repeat with each pole section until you reach desired height for filming. (2) Lock the black 25' cable (not the tilt reel cable) into each carabineer as you raise each pole section. This will prevent the cable from tangling and flapping in the wind. **IMPORTANT** The pole with the pant/tilt handle and tilt reel connected to it should not be raised.

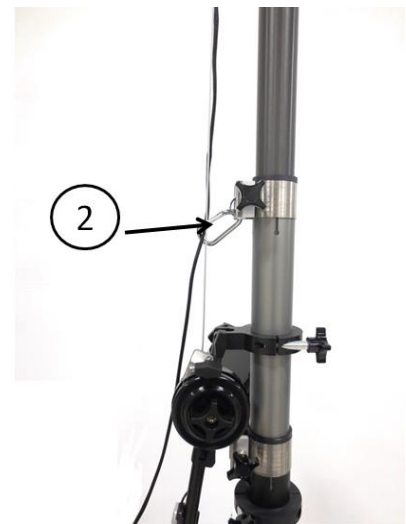
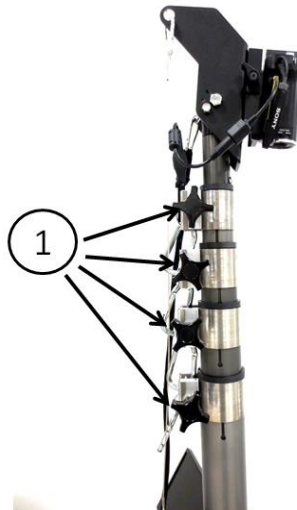
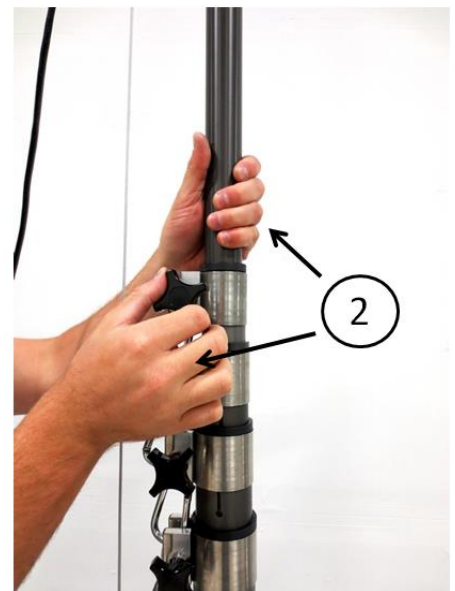
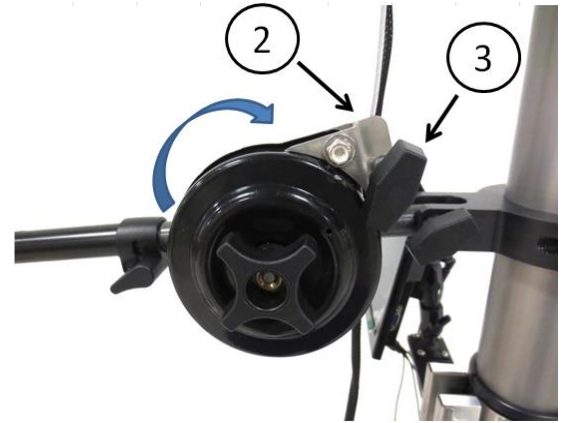

Now it is time to position the tilt reel to allow you to pan and tilt the camera. **IMPORTANT** Make sure your camera is facing straight down to the ground and that there is no slack in the tilt reel cable. (1) Lift the remote handle and then loosen the four-arm knob as shown. (2) Turn the tilt reel back towards you as shown. (3) Then tighten the black t-handle knob until the tilt reel cable is locked into place.

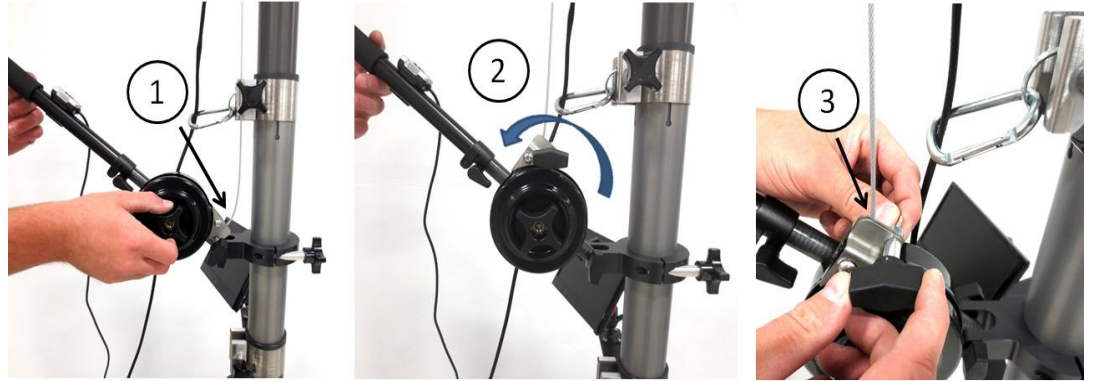

(1) To tilt the camera down, raise the remote handle up as shown. The camera tilt plate is spring loaded to move the camera down. (2) To tilt the camera up, pull the remote handle down.

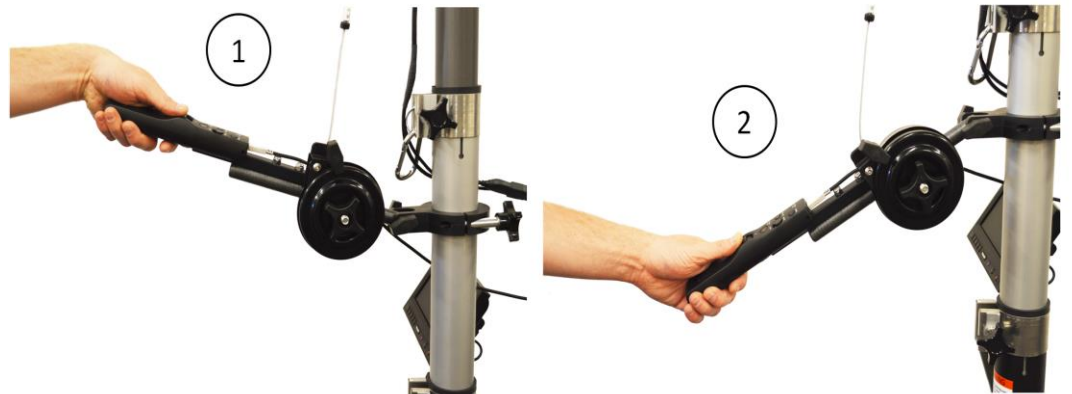

(1) To pan the camera to the right, move remote handle to the left as shown. (2) To pan the camera to the left, move the remote handle to the right. (3) To zoom in/out and record, use the camera remote with your thumb as shown.



(1) To change the tension on the tilting handle, tighten the two t-handle knobs as shown. More tension will allow you to leave the camera at a fixed position while less tension will allow you to tilt quicker. (2) To raise or lower the tilt reel and pan/tilt handle, loosen the small knob attached to the black collar and slide to desired height and tighten.



(1) To change the tension on the panning of the tower, tighten or loosen the black knob as shown. (2) To raise or lower the monitor swivel mount, loosen the small knob attached to the black collar and slide to desired height and tighten.



Take Down Instructions

(1) Loosen the black t-handle knob attached to the tilt reel. This will allow the tilt reel cable to retract when lowering the tower. (2) Loosen four-arm knob and (3) rotate the tilt reel forward as shown. Then tighten the four-arm knob against the tilt reel.



IMPORTANT (1) Slightly loosen the black knob with one hand while (2) holding the next pole up with your second hand. Once the pole is loose enough to slide down, (3) **slowly** begin bringing down the pole in a slow and controlled manner by using **both hands**. When the first pole section is all the way down, tighten the black knob back into place. Continue with each pole to completely lower the tower

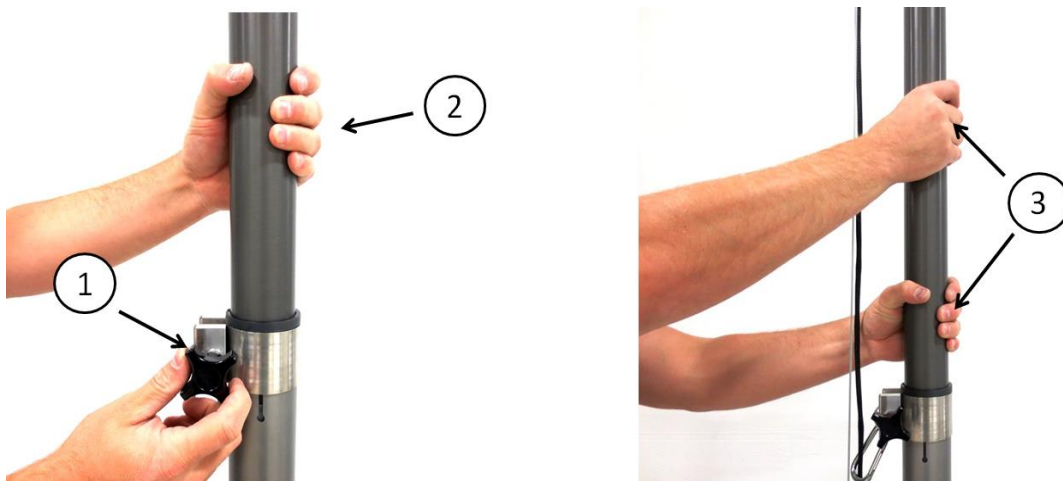

IMPORTANT (1) Once the tower is completely lowered, like shown, tighten and align all the knobs before you store in the travel bag. (2) Also, make sure to tighten the panning tension knob before taking the tower out of the wheel plate to store in the travel bag.

Finally disconnect cable and store in travel bag. Then take off camera, monitor, and camera remote and put into hard case. Take off camera tilt plate, remote handle, and tilt reel and store in the correct spots in the hard case or travel bag. Close the legs of the tower and place tower in travel bag. Finally, put wheel plate back on the bag, then zip up the travel bag and store for next time.

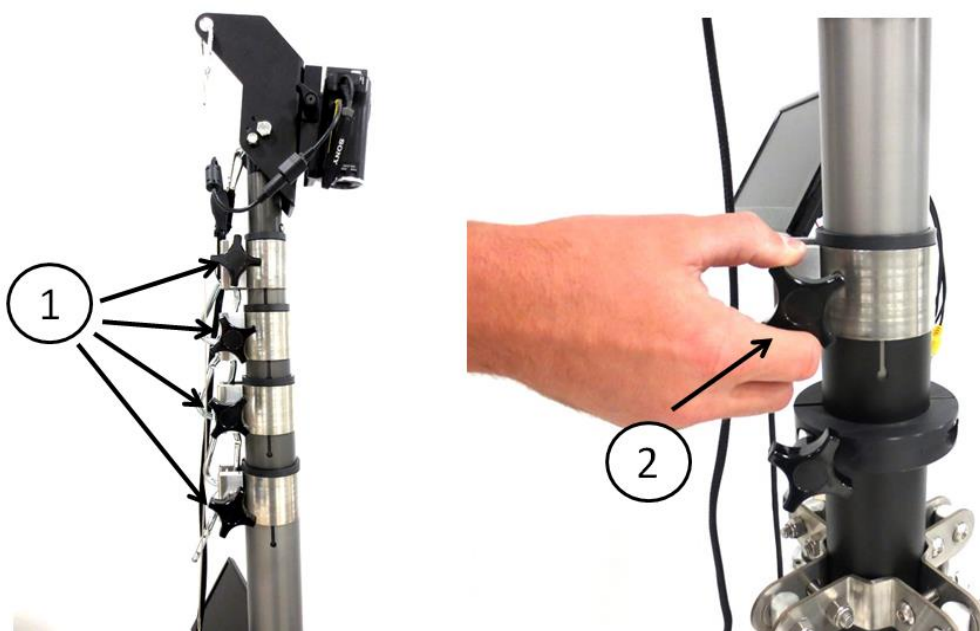

Rain Gear Instructions

Take lens hood out of rain gear pocket and (1) unscrew the wing nut for the attached bolt. (2) On top of the lens hood is a nut to hold the black rain cover into place, see below. (3) Place the bolt through the slit of the camera tilt plate as shown. Then tighten the wing nut back into place.



(1) Now slide the camera forward by using the quick release plate. Position the camera and lens hood so the lens hood does not block the camera's view. (2) Take out the black waterproof cover from the rain gear pocket and open the large Velcro opening. Slide the cover over the camera and camera tilt plate. (3) Tighten the bungee around the lens hood making sure it does not block the camera's view. Close the other bungee opening and then close the bottom Velcro opening.



(1) Pull out the white rain cover and place the small bungee end over the remote handle as shown. Reach your hand into the larger end to use the camera remote. (2) Finally, take out the clear plastic monitor cover and place over the monitor and monitor battery as shown.

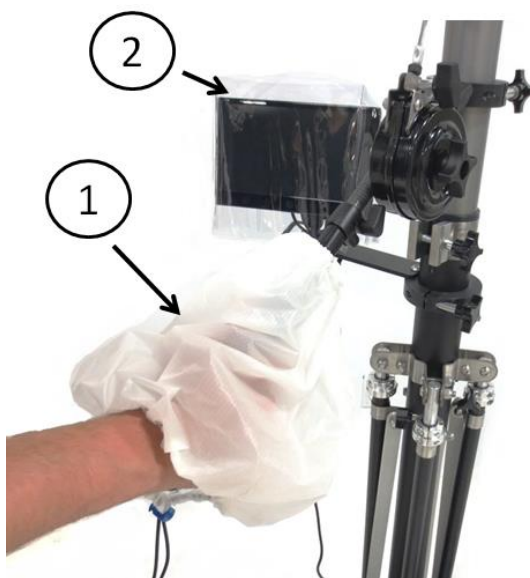

Battery Instructions

The 25' Sport Scope has three battery sources that power the monitor and the camera

Extended USB Camera Battery: lasts 5-6 hrs.

Internal Camera Battery: lasts 45min-1hr.

Monitor Battery: lasts 4-5 hrs.

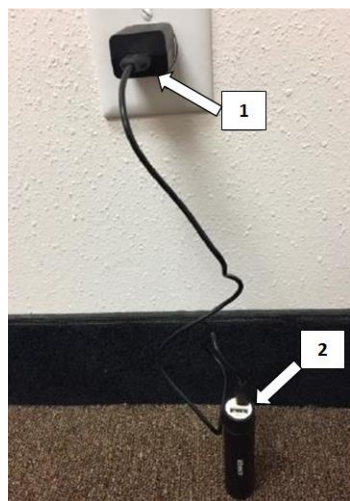

To charge extended USB camera battery, (1) attach USB charging cable to a USB wall outlet (you may use Sony USB to AC adapter that came with camera). (2) Attach the micro USB end to your extended USB camera battery. Charge the battery for 4-5 hrs. or until the LED light has been green for at least 2 hrs.

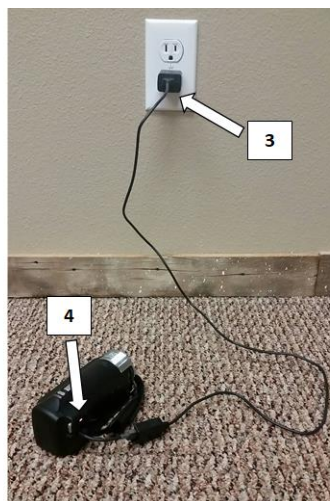

To charge internal camera battery first make sure camera viewfinder is **closed**. (3) Attach USB charging cable to a USB wall outlet and connect to USB connector on camera. (4) A yellow LED light will indicate charging. Charge until light turns off.



DO NOT USE THE SIDE USB PORT TO CHARGE YOUR CAMERA OR EXTENDED BATTERY!

To charge monitor battery, (5) attach battery to wall charger and plug the charger into wall outlet. The charger's light will turn red when charging and back to green when completely charged. This may take up to 8 hours. Do **not** leave battery on charger for more than 24 hrs.

Transferring Video to Computer

The camera records the video to the micro SD memory card. To transfer the video to your computer for viewing or editing, (1) Tap the micro SD card inward into the camera slot so that it releases and then remove. (2) Insert micro SD card into standard SD adapter card.

(3) Insert standard SD card into computer SD slot.

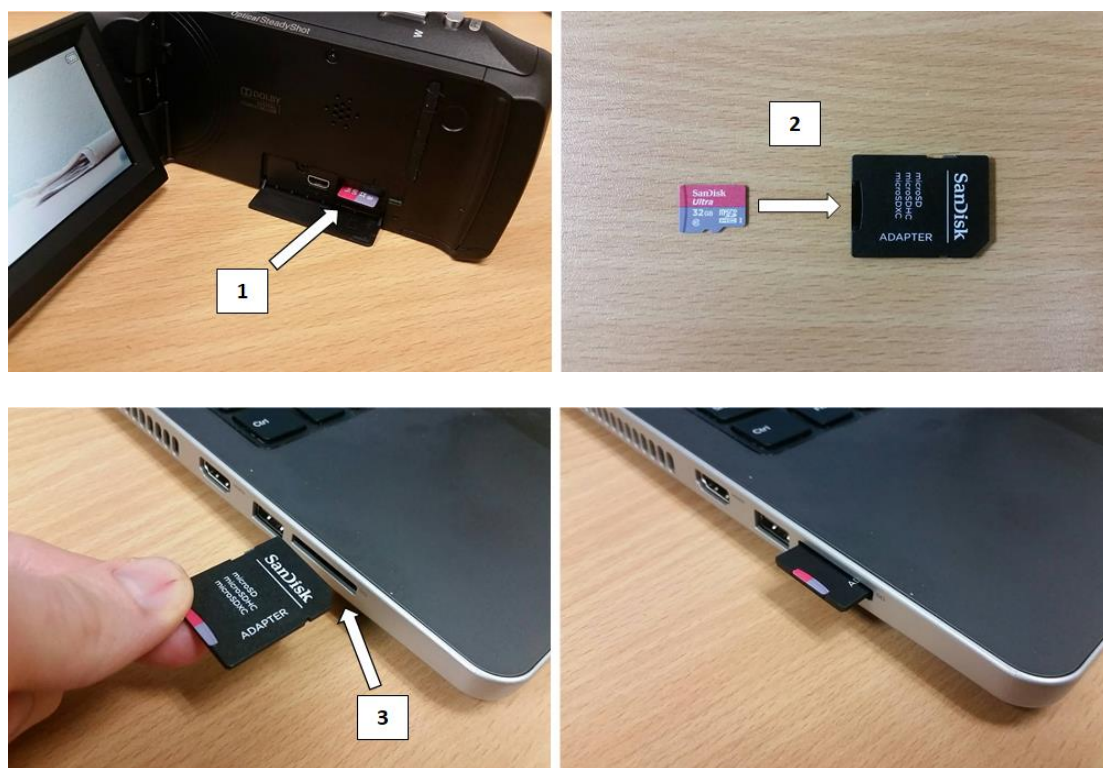

On your computer (Windows), open your file explorer and select the memory card in the side panel.

You will then be in the memory card:

- 1) Open folder PRIVATE
- 2) Open folder AVCHD
- 3) Open folder BDMV
- 4) Open folder STREAM

Find the clips you want and drag them to your desktop or into your editing software.

To fully clear all data on the memory card you may accomplish this when the memory card is in the camera:

Go to Menu > Setup > Format > Select OK to delete all data.

